

# 衬氟隔膜阀 Lined Diaphragm Valve

## 材料明细表 Material Specification

公称通径 Nominal Diameter		DN15-DN250, 1/2"-10"		
公称压力 Nominal Pressure		1.0MPa 1.6MPa 150LB		
No.	名称 Name	材料明细 Material Lists		
1	锁紧螺钉 Lock screw	A193 B8	A193 B8	A193 B8M
2	内六角螺钉 Screw	A193 B8	A193 B8	A193 B8M
3	手轮 Handwheel	WCB CF8		
4	钢套 Sleeve	SS304		
5	阀盖 Bonnet	WCB	CF8	CF8M
6	阀杆螺母 Stem nut	黄铜 Brass		
7	阀杆 Stem	2Cr13	A182 304	A182 316
8	调整垫 Adjustable pad	SS304		
9	阀瓣 Disc	WCB	CF8	CF8M
10	橡胶隔膜片 Rubber Diaphragm	EPDM		
11	隔膜片 Diaphragm	PFA FEP GXPO		
12	阀体 Body	WCB+ 衬里材质 Lining material	CF8+ 衬里材质 Lining material	CF8M+ 衬里材质 Lining material
13	螺母 Nut	A194 2H	A194 8	A194 8M
14	平垫圈 Flat washer	45#	A182 304	A182 316
15	外六角螺钉 Outer hexagonal screw	A193 B7	A193 B8	A193 B8M

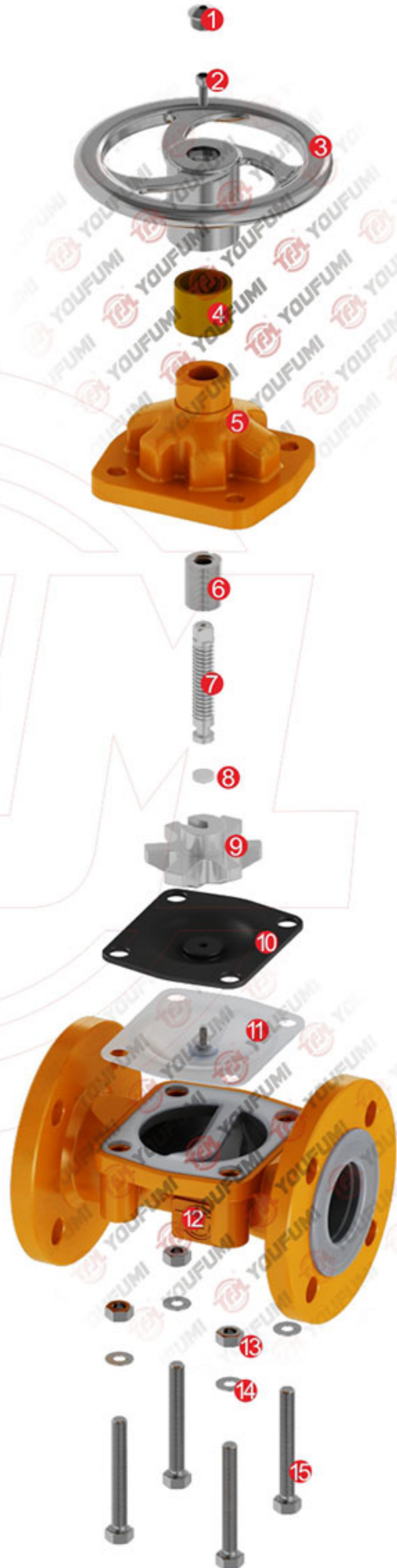

## 技术性能规范 Technical Specification

设计标准 Design & Manufacture Standard		HG/T 3704, GB/T 12239		MSS-SP-88
结构长度标准 Face-to-face Dimension Standard		HG/T 3704, GB/T 12221		EN 558-1
法兰标准 Flange Standard		HG/T 20592, GB/T 9119		ASME B16.5, JIS B2220
检验与试验标准 Inspection and Test Standard		GB/T 13927, JB/T 9092		API 598
公称通径 Nominal Diameter		DN15~DN250		1/2"~10"
公称压力 Nominal Pressure		1.0MPa	1.6MPa	150LB
试验压力 Test Pressure	壳体试压 Shell Test	1.5MPa	1.5MPa	1.5MPa
	高压密封 High Pressure Sealing	1.1MPa	1.1MPa	1.1MPa
	低压密封 Low Pressure Sealing	0.6MPa	0.6MPa	0.6MPa
适用温度 Temperature Range		PFA: -29°C~200°C PTFE: -29°C~180°C FEP: -29°C~150°C GXPO: -10°C~80°C		
适用介质 Applicable Medium		盐酸、硝酸、氢氟酸、液氯、硫酸、王水等强腐蚀性介质 Strong corrosive medium i.e. hydrochloric acid, Nitric acid, Hydrofluoric acid, Liquid chlorine, Sulfuric Acid and Aqua regia etc.		

特注：衬氟阀门壳体试压和密封按温度压力曲线进行，仅参考通用阀门测试标准。

Note: Test standard refers general valve standard, high pressure should be customized for processing.

## 流量特性图 Flow Characteristic

典型固有流量特性  
Classic Fixed Flow Characteristic

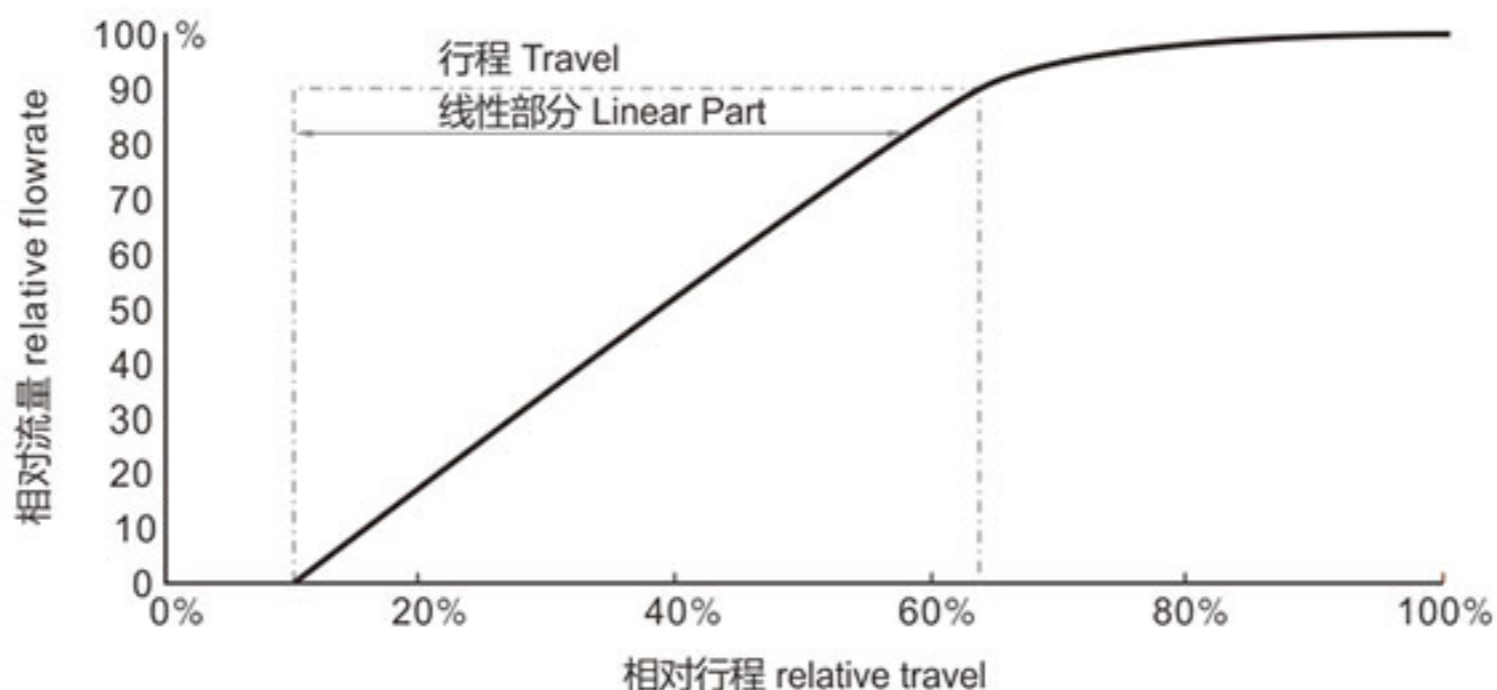

# 衬氟隔膜阀 Lined Diaphragm Valve

氟塑料压力温度曲线  
Pressure-Temperature Curve

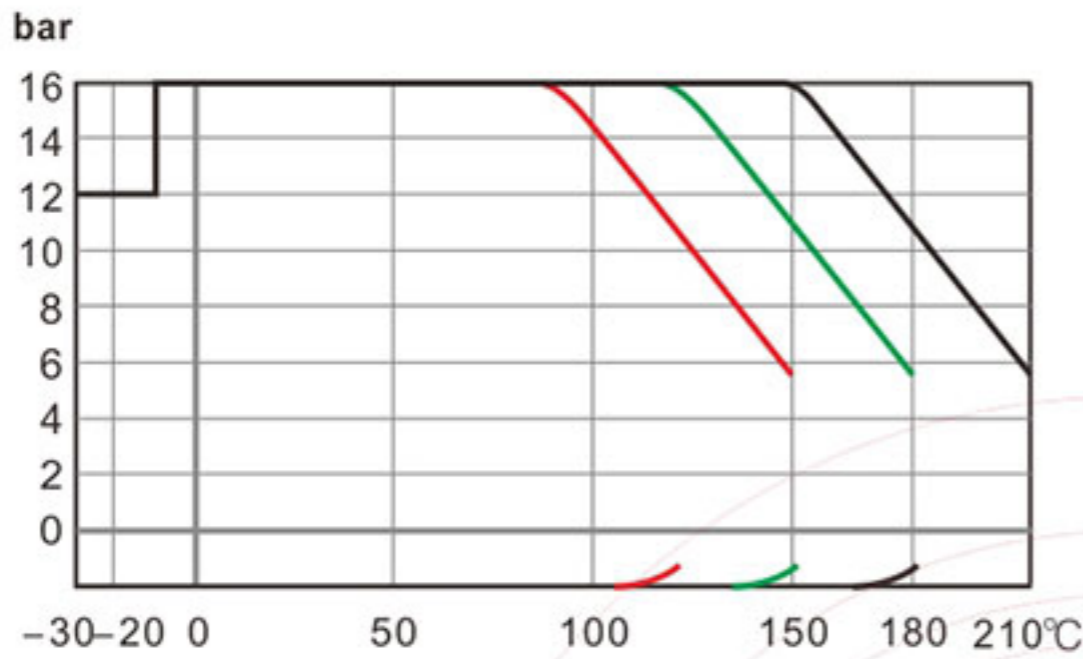

真空 Vacuum: 0.1mbar

备注 Note: — PFA — PTFE — FEP

衬氟隔膜阀温度压力曲线图  
Pressure-Temperature Curve

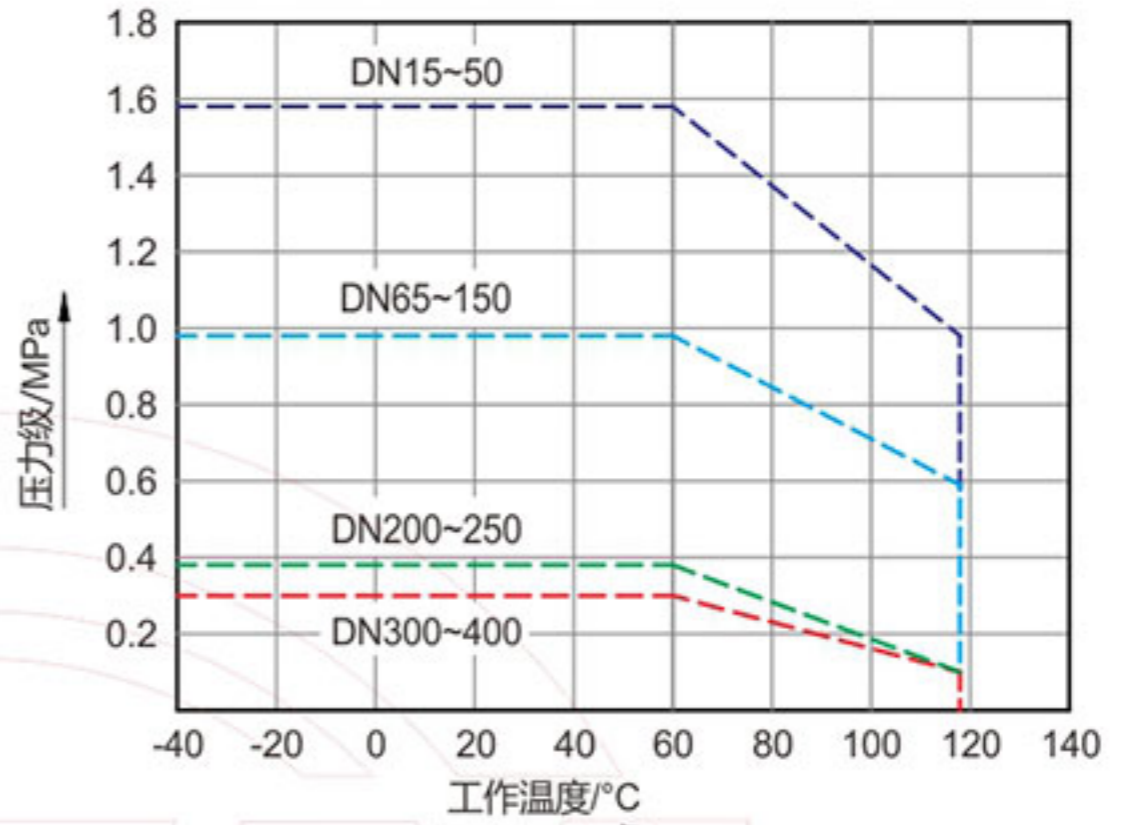

## 结构特点 Structure Features



(1)限位原理 Limit principle

(2)密封副原理 Sealing principle

## 注意事项

- 使用温度不允许超过规定范围。
- 使用介质不允许有较硬颗粒，以免压伤密封面，影响阀门密封。
- 隔膜片升降次数不宜太多以免损坏隔膜片影响密封性能。
- 流量小。

## Note

- Not exceed a predetermined temperature range.
- The media does not allow hard particles to prevent crushing the sealing surface, affect the sealing performance.
- Diaphragm rise and fall times not too much, to avoid damage to the diaphragm, affect the sealing performance.
- Low flow

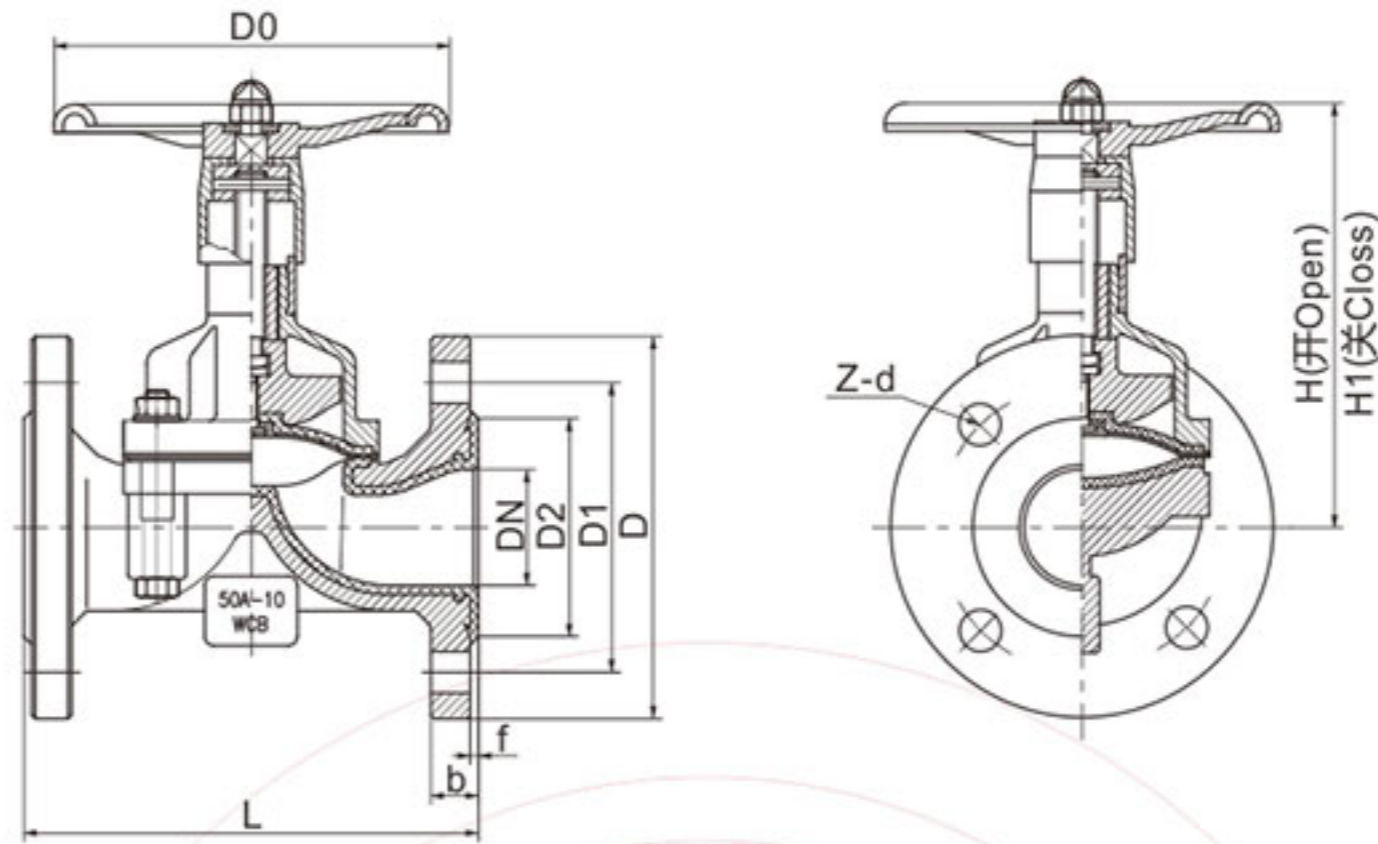

YFM-G41PFA/F4/F46/GXPO-6/10/16

HG/T 20592 PN6

单位Unit:mm

DN	L	D	D1	D2	Z-d	f	b	H	H1	D0	Wt(Kg)
15	125	80	55	40	4-12	2	12	126	116	120	2.8
20	135	90	65	50	4-12	2	14	126	116	120	3
25	145	100	75	60	4-12	2	14	140	127	140	4.5
32	160	120	90	70	4-14	3	16	149	132	140	6.5
40	180	130	100	80	4-14	3	16	175	155	160	8
50	210	140	110	90	4-14	3	16	188	162	180	10
65	250	160	130	110	4-14	3	16	230	196	220	16
80	300	190	150	125	4-18	3	18	262	220	250	21
100	350	210	170	145	4-18	3	18	325	272	280	30
125	400	240	200	175	8-18	3	20	397	332	320	52
150	460	265	225	200	8-18	3	20	450	372	360	70
200	570	320	280	255	8-18	3	22	600	496	400	112
250	680	375	335	310	12-18	4	24	700	570	450	220

HG/T 20592 PN10

15	125	95	65	45	4-14	2	14	126	116	120	3
20	135	105	75	55	4-14	2	14	126	116	120	3.4
25	145	115	85	65	4-14	2	14	140	127	140	5.5
32	160	140	100	78	4-18	3	16	149	132	140	7
40	180	150	110	85	4-18	3	16	175	155	160	9
50	210	165	125	100	4-18	3	16	188	162	180	12.5
65	250	185	145	120	4-18	3	18	230	196	220	20
80	300	200	160	135	4-18	3	20	262	220	250	26
100	350	220	180	155	8-18	3	20	325	272	280	36
125	400	250	210	185	8-18	3	22	397	332	320	60
150	460	285	240	210	8-22	3	24	450	372	360	80
200	570	340	295	265	8-22	3	26	600	496	400	125
250	680	395	350	320	12-22	4	28	700	570	450	240

注：更多尺寸，请联系有氟密工程师。

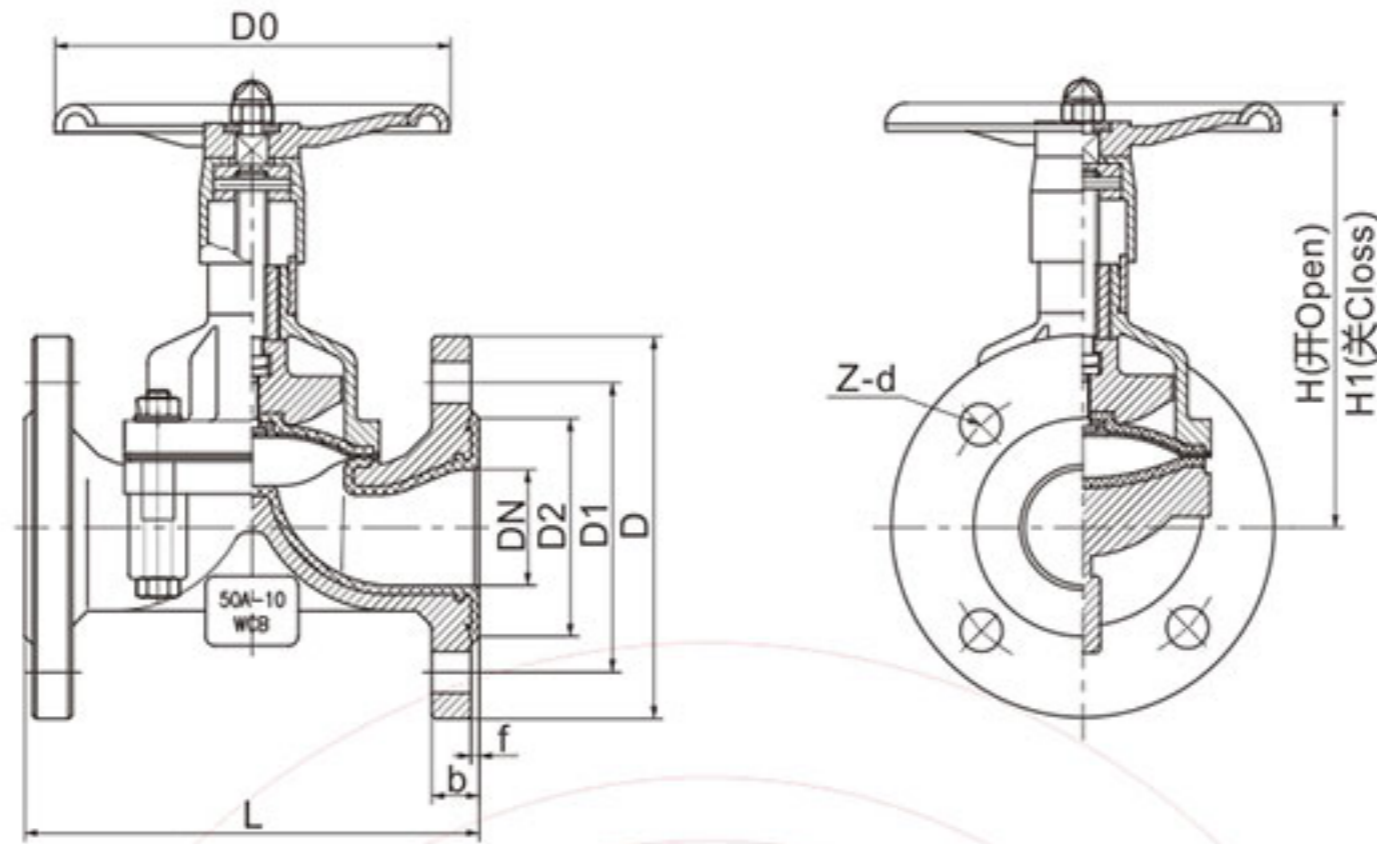

YFM-G41PFA/F4/F46/GXPO-150LB

HG/T 20592 PN16

单位Unit:mm

DN	L	D	D1	D2	Z-d	f	b	H	H1	D0	Wt(Kg)
15	125	95	65	45	4-14	2	12	126	116	120	2.8
20	135	105	75	55	4-14	2	14	126	116	120	3
25	145	115	85	65	4-14	2	14	140	127	140	4.5
32	160	140	100	78	4-18	3	16	149	132	140	6.5
40	180	150	110	85	4-18	3	16	175	155	160	8
50	210	165	125	100	4-18	3	16	188	162	180	10
65	250	185	145	120	4-18	3	16	230	196	220	16
80	300	200	160	135	4-18	3	18	262	220	250	21
100	350	220	180	155	8-18	3	18	325	272	280	30
125	400	250	210	185	8-18	3	20	397	332	320	52
150	460	285	240	210	8-22	3	20	450	372	360	70
200	570	340	295	265	12-22	3	22	600	496	400	112
250	680	405	355	320	12-26	4	24	700	570	450	220

ASME B16.5 Class150

1/2	110	90	60.5	35	4-16	2	12	126	116	120	3
3/4	117	100	70.0	43	4-16	2	12	126	116	120	3.4
1	127	110	79.5	51	4-16	2	14	140	127	140	5.5
1 1/4	140	115	89.0	64	4-16	3	16	149	132	140	7
1 1/2	165	125	98.5	73	4-19	3	17.5	175	155	160	9
2	178	152	120.5	92	4-19	3	19	188	162	180	12.5
2 1/2	190	180	139.5	105	4-19	3	22	230	196	220	20
3	203	190	152.5	127	4-19	3	24	262	220	250	26
4	229	230	190.5	157	8-18	3	24	325	272	280	36
5	254	255	216.0	186	8-18	3	24	397	332	320	60
6	267	280	241.5	216	8-23	3	25.5	450	372	360	80
8	292	345	298.5	270	8-23	3	28.5	600	496	400	125
10	330	405	362.0	324	12-23	4	30	700	570	450	240

Note: For more size, please consult our engineer.